

Lesson 6 Problem-Solving Practice

Area of Composite Figures

ARCHITECTURE For Exercises 1–6 use **Jaco’s preliminary design of his vacation house at the right**. Round to the nearest tenth if necessary.

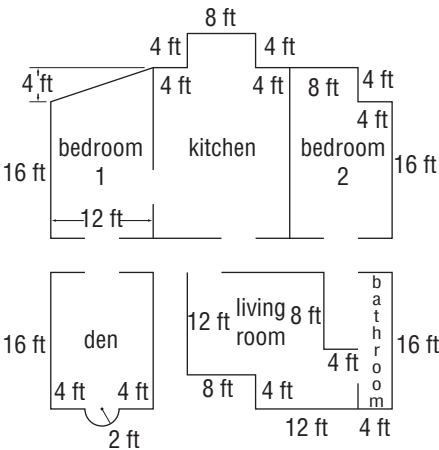

<p>1. What type of figure is bedroom 1? Find the area of bedroom 1.</p>	<p>2. What is the area of the bedroom 2? What figures did you use to find the area?</p>
<p>3. What is the area of the bathroom? What are the dimensions of the figures you used to find this area?</p>	<p>4. What is the area of the living room? How many figures did you use to find this area?</p>
<p>5. What would the area of the den be if the semicircular window were removed and replaced with a flat window?</p>	<p>6. What is the area of the kitchen? If Jaco adds a rectangular cooking island in the middle of the kitchen with dimensions 6 feet by 4 feet, how many square feet of space will be left?</p>